

Combining Our Agricultural and Quilting Heritage



The Idea

The idea of barn quilts began in Adams County, Ohio in 2001. Donna Sue Groves painted a quilt block on the side of an old tobacco barn for her mother, a quilter. She soon realized she had created a tourist attraction for her county that has spearheaded the barn quilt movement throughout rural America.



The first Truman area Barn Quilts

Here in Truman, the Barn Quilt movement began when Rhonda Kuhlman painted several quilt blocks onto her shed, shown above. The idea also quickly took off in the area, and soon friends and neighbors were being asked about putting quilt blocks up on their barns. Now, you can find a number of area Barn Quilts hung on more than just barns. Bremer and Daughters (shown below) have chosen to hang "Barn Quilts" on their fence at the end of their driveway, which they change with the seasons and holidays. Some choose to decorate small sheds, others mailboxes. Some now display quilt squares as small garden stakes. However you see them, or even choose to display them yourself, we hope you enjoy both the craft and heritage that Barn Quilts represent!



Seasonally changing Barn Quilts

Truman Quilts

11. *Dick and Pat Eckmann* - W 5th St N (2198 240th St.) Truman - **Martha Washington Star**
12. *Penny Ritter* - 202 E Ciro St - (garage behind pink house) **Sunbonnet Sue & Dog** (Sue has real lace on bonnet and dog has real dog tag)
13. *Thad's Timless Treasures* - 142 West Ciro Truman - **Pinwheel** (see upper window)
14. *Truman Public Utilities* - 202 W Ciro Truman - **Star of Bethlehem**
15. *Mane Fringe* - 133 W Ciro Truman - **Star Variation**
16. *Truman Museum* - 109 W Ciro St **Ohio Star with Museum Logo in center.** Memorial to Gene Mager and Morgan Tennyson
17. *John & Joanne Sherman* - 210 S 7th Ave E - (quilt over garage door)

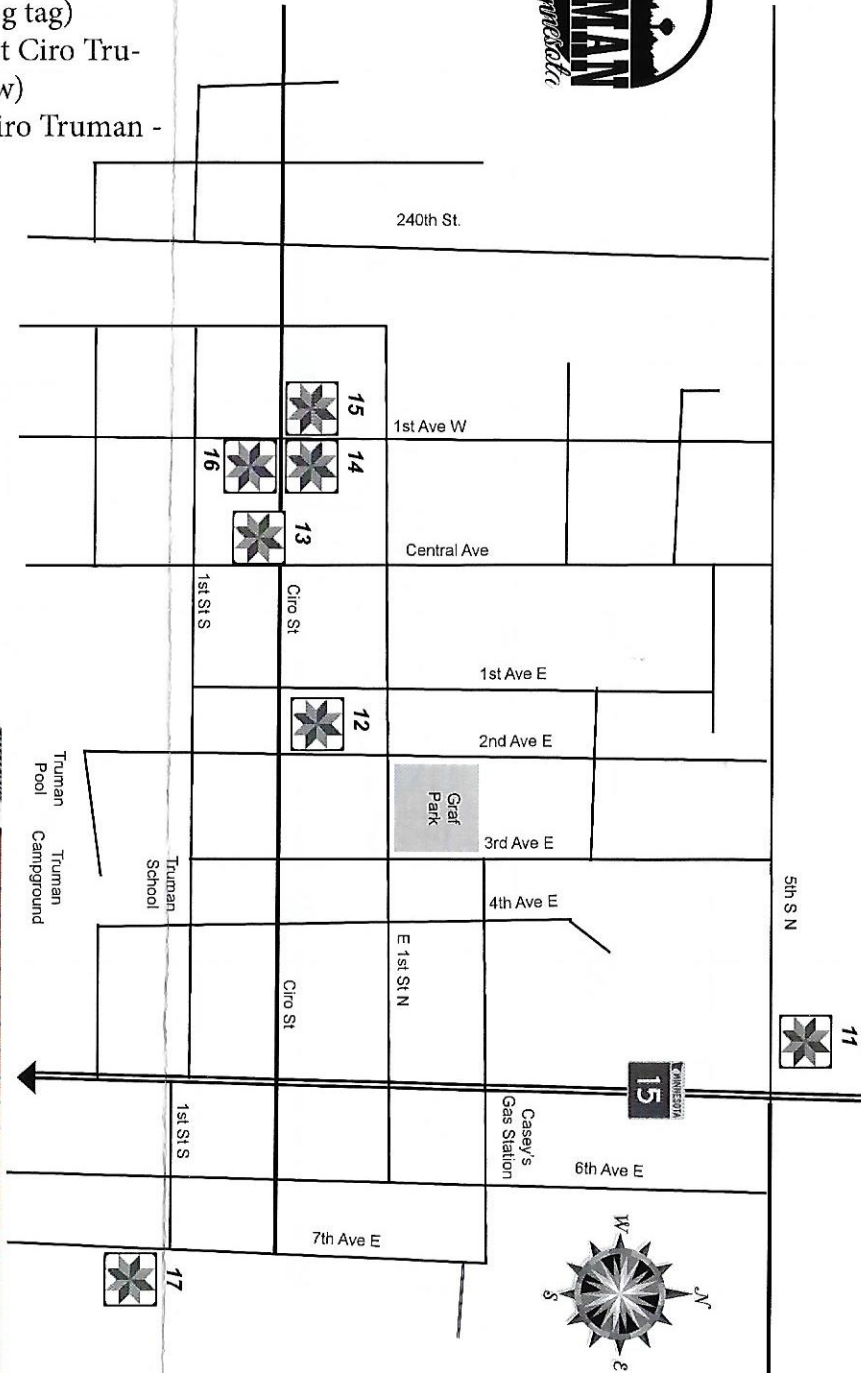

Barn Quilts Trail Map

Truman, MN Area

For more information about Barn Quilts, please
contact the Truman Historical Museum at
(507) 776-7889 or (507) 436-5505

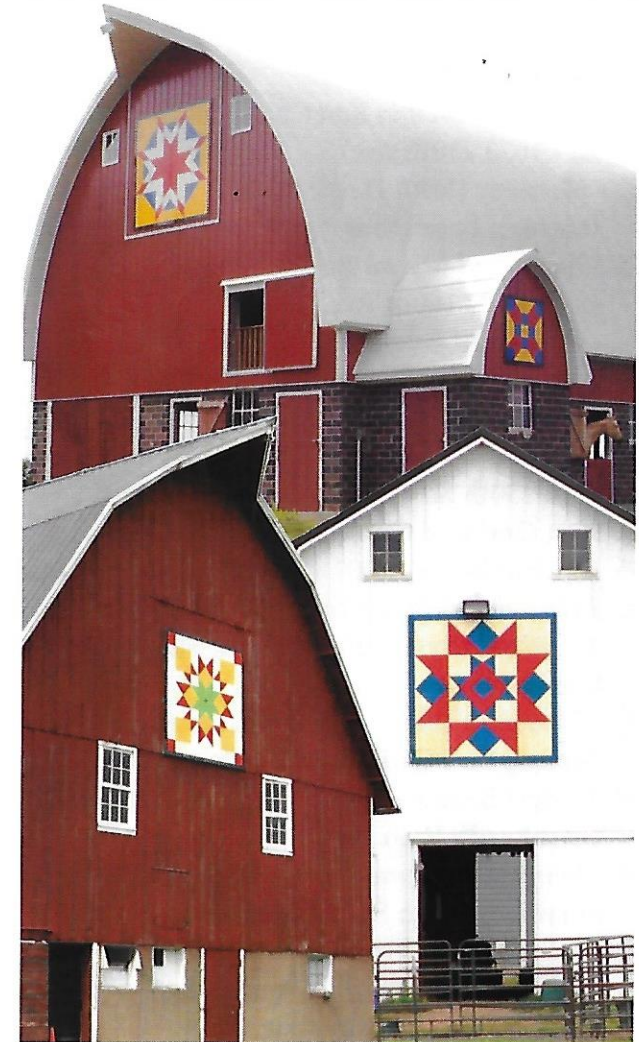
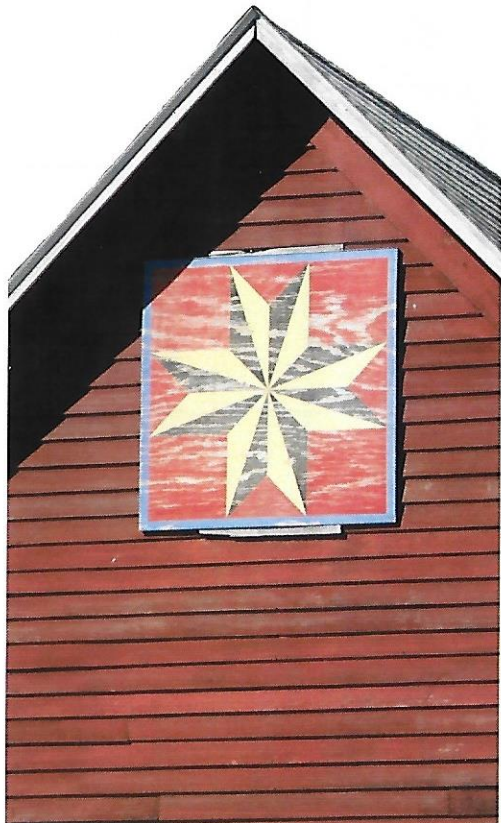

Truman Area Barn Quilt Trail

Addresses and Quilt Descriptions

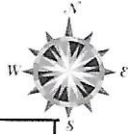

Addresses and Descriptions

1. *Robert Luther* - 37229 790th Ave. (3 quilts) 8x8 **Level Four**, 6x6 **Checkerboard**, 6x6 **Ohio Star**
 2. *Chad Urevig* - 37126 Hwy 15 (5 quilts) MN **Block**, (shed) **Maple Leaf**, **Milky Way**, **Palm Leaf**, **Big Dipper**
 3. *Mike and Susan Haycraft* - 38361 Hwy 15 Lewisville - **Dutch Barn Roof** (double sided) plus various others on outbuildings
 4. *Retzie Mohwinkel* - 83392 Hwy 30 - **North Star**
 5. *Alan Tadd* - 41245 830th Ave - **Blazing Star**
 6. *Jane Traver* - 83997 420th St - **Bridle Path**
 7. *Lyle Greiner* - 82109 420th St - **Trip Around the World**
 8. *Curtis and Pat Jones* - 43637 Hwy 15 - **Road to Damascus**
 9. *James and Barb Shoen* - 2143 250th St - **Stepping Stone**
 10. *Dallas Becker* - 2486 Hwy 15 - **Star Flower**
- Quilts 11-17 on Truman Map on back**
18. *Dave and Lin Hendricksen* - 2808 240th St. - **A Dog's Life**
 19. *Ron and Bea Schultz* - 2338 250th Ave - **Wind-blown**
 20. *Arnold and Lila Kesler* - 2295 Hwy 15 - **Farmer's Daughters** and **Pinwheel**
 21. *Arnold and Donna Bentz* - 2188 220th St (2 quilts - lit at night) 8x8 **Harvest Star**, 4x4 **Fence Post**
 22. *Waverly Town Hall* - 2204 160th Ave.
 23. *Jeff and Jodi Lueth* - 2258 150th Ave - **My Mother's Star**
 24. *Robert and JoAnn Hilgendorf* - 1348 220th St - **Carpenter's Wheel**
 25. *Waverly Lutheran Church* - 1333 220th St.
 26. *Jerry and Kimberly Fast* 2106 210th St. (2 quilts)
 27. *Kirk and Kay Vogt* - 2084 Hwy 15 - **Diamond Star**
 28. *Brad and Lauri Sherman* - 2191 240th Ave. - **Mrs. Holm's Diamond**
 29. *Roger and Anita Block* - 2134 250th Ave. - **Windmill**
 30. *Larry and Annette Bremer* - 1948 Hwy 15 - (**Fence Corner Barn Quilts that change with the seasons**)
 31. *Craig and Marilyn Carrigan* - 1893 230th Ave. - **Evening Star** and **Carolina Lily**
 32. *Roger and Brenda Kotewa* - 1673 230th Ave - **Memory (John Deere Tractor)**, **Laced Star**
 33. *Duane and Myrna Behrens* - 1692 160th Ave. - **Garden of Eden** (3 stars stand for Father, Son and Holy Spirit)
 34. *Dan and Lori Krome* - 2116 150th St. - **Lori's Star**, **God and Country**
 35. *Mildred Brodt* - 1807 140th St. - **Blazing Star**
 36. *Michael and Becky Tonne* - 2464 140th St.
 37. *Heritage Acres* - 507 Lake Ave. Fairmont - **Blazing Star**
 38. *Meadows Condos* - 1310 Adams Ave Fairmont - **Blazing Star Quilt** on shed along path
 39. *Bridget Becker* - 2929 Fairway Dr. Fairmont - **Drunkard's Path**
 40. *Dennis and Diane Wedel* - 682 180th Ave. - (view from 70th St.) **Carpenter's Wheel**
 41. *Rick Smith* - 2584 50th St. - **Tête-à-tête**
 42. *Gordon and Loretta Luckow* - 829 245th Ave. - **North Star** and many more

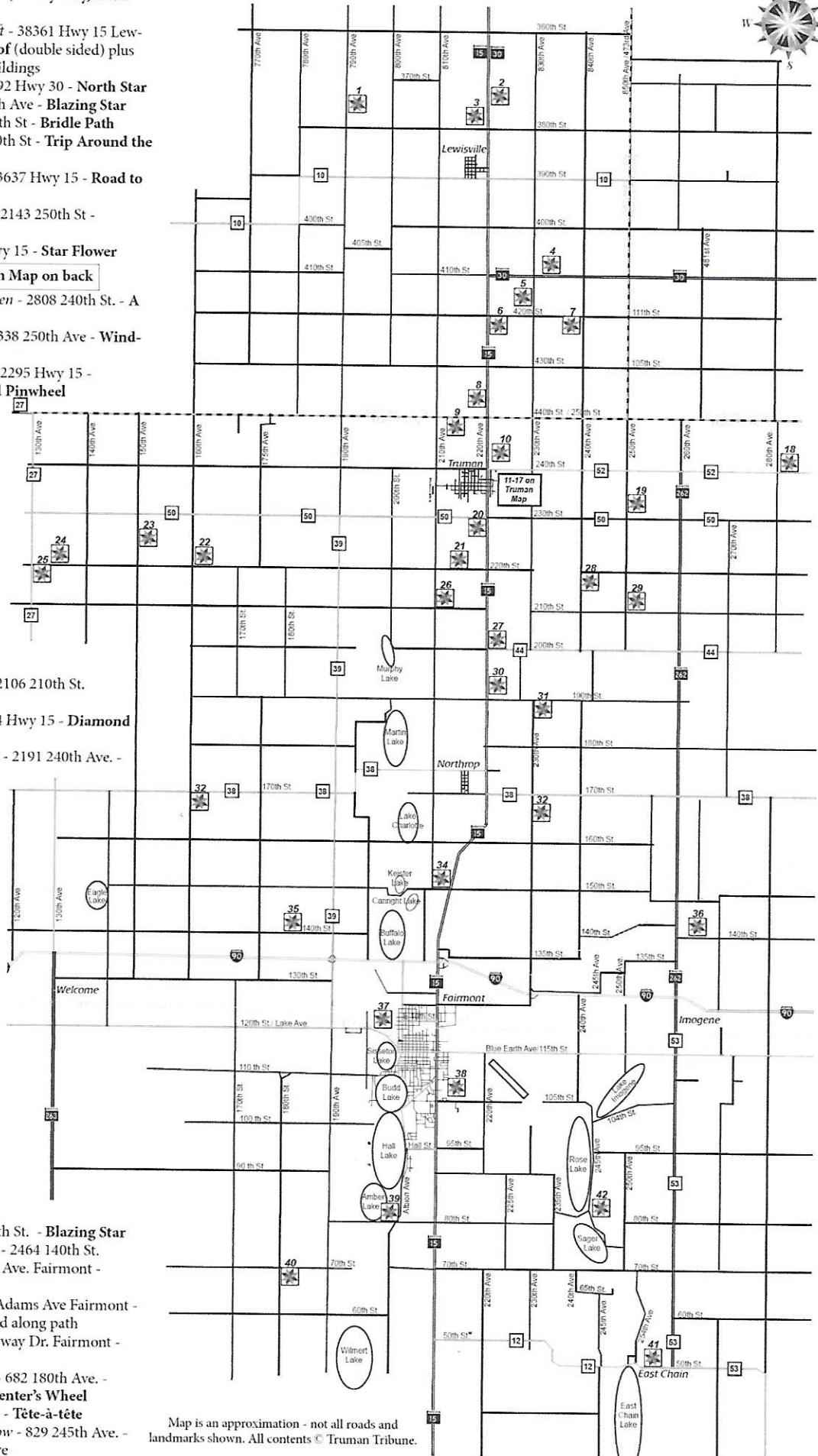

Map is an approximation - not all roads and landmarks shown. All contents © Truman Tribune.